

Technology. Innovation. Commitment.



Sharp Pumps Pvt. Ltd.,

Point Arcade, Sharp Nagar, Kalappatti, Coimbatore 641 048. TN, INDIA
Ph : 90477 77757, 97861 97100. Email : marketing@pointpumps.com

Email : exports@pointpumps.com

www.pointpumps.com



Enhance your life

Decanting Pump



Decantation is a process for the Separation of mixtures by removing a layer of liquid, Generally one from which a precipitate has Settled. A Mixture of an insoluble solid in liquid is allowed to Stand. If the solid is more dense than the liquid it will settle at the bottom. If kept undisturbed for some time.

The Decanting pumps ensure that only the supernatant water without any entrapment of solids. The installed pump goes up and down with the liquid. It can suck clear water from between the sludge at the bottom and foam or floating debris at the surface. Once switched on it will start pumping if its inlet is in clear water. It will continue emptying the tank until a sensor warns of the water near the pump inlet becoming cloudy.

Model Identification

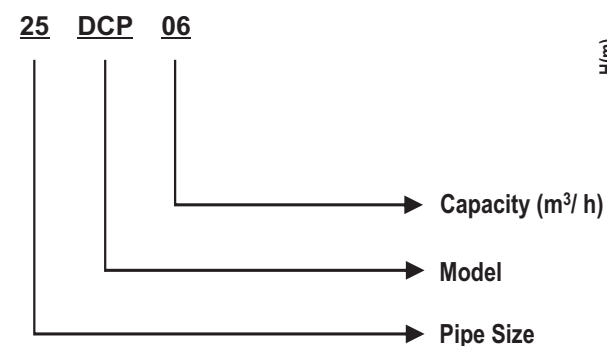

Performance curve

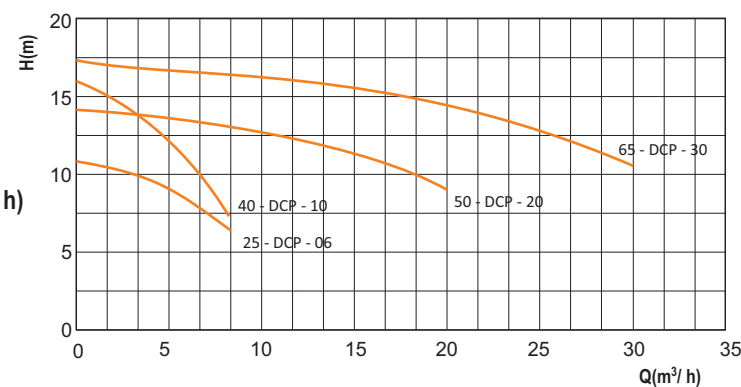

Performance Table

Pipe Size (mm)	Model	Power (HP/kW)	Phase	Max head (m)	Max Discharge (lph)
25	25 - DCP - 06	0.5 / 0.35	1P	10	6000
40	40 - DCP - 10	0.6 / 0.35	1 / 3P	10	10000
50	50 - DCP - 20	1.5 / 1.1	1 / 3P	12	20000
65	65 - DCP - 30	2.0 / 1.5	1 / 3P	15	30000

Material of construction

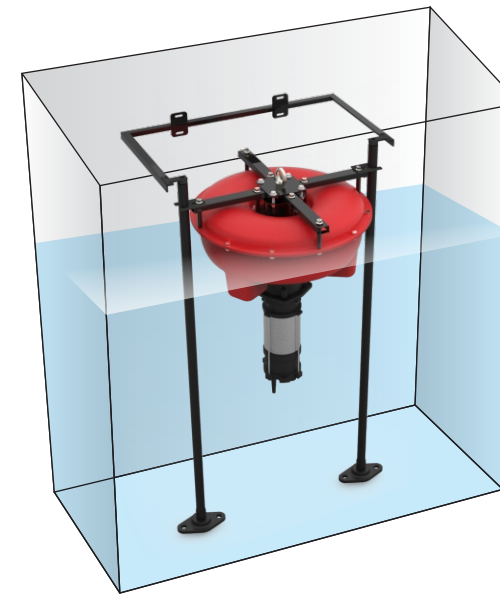

Pump	: Casing - GG20 Impeller - GG20 / SS 420
Motor Body	: SS 304
Motor Shaft	: SS 420 / SS 431 Induction Hardened
Cable	: Rubber Cable HO7RNF
Bearing	: Shielded Ball Bearing / Journal bearing for water filled motor
Motor	: 2P, IP: 230V, 3P : 420V
Discharge Connection	: Flange and Hose coupling.
Suction	: With NRV (Spring Loaded)
Float	: Fiber Reinforced Plastic Filled with PUF

Controllers

The Decanting pump unit with light sensor (optional attachment) operates the pump ON and OFF independently. It is the safest, Failure proof and trouble free operations of the pump. Light Sensor detect the surrounding and reflected light density variation and send the signal to control unit, to either ON or OFF the pump.

Control Panel

- The Pump is activated through a Float switch from the Panel. Float switch is used to control high water level and low water level.
- Protection : For single phase, High and low amphere control.
For three phase, single phase preventer with high load controller .
- Voltage, current indicator and emergency switch to stop the operation - Optional



Dimension Details

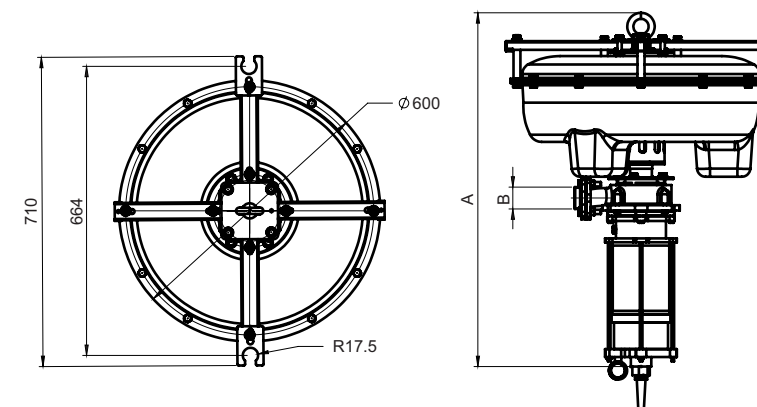

Model	A	B
25 - DCP - 06	310	25
40 - DCP - 10	500	40
50 - DCP - 20	550	50
65 - DCP - 30	580	65